

East Fairfield Residential Master Plan, Sydney, Australia

with EDAW, 1998

Client: Bellevale Homes

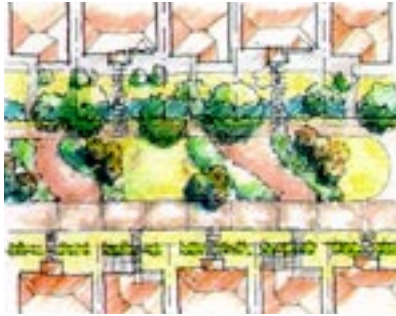

Plan detail (by EDAW design team)



Perspective (by EDAW design team)

The East Fairfield site is approximately 8.28 ha, rectangular in shape with frontage and access from all existing streets and is relatively flat. My responsibility was to work with the residential developer, Bellevale Homes, to produce an urban residential master plan for Landcom, a state government agency. The precinct accommodates approximately 500 residents and a local park. The precinct is based on traditional planning principles with visual axes and pedestrian links capturing a view to the local park and fronted by housing, serviced through laneways. The supporting streets and housing types were designed to continue the existing fabric of the neighborhood with a street tree upgrade on adjacent streets to facilitate a better transition.



Master Plan (By EDAW design team)