

Taylor Square, South Sydney, NSW

with EDAW, 1999

Client: South Sydney Council



Overall perspective

Taylor Square is a significant public space in South Sydney and is adjacent to the Sydney Central Business District. The Square has pubs and cafes to the south and east with the Supreme Court of New South Wales to the north. The construction of the Eastern Distributor tunnel necessitated traffic re-configurations and the closure of one of the roads, dramatically changing the continuity of the space and provided two large public spaces trisected by two arterial roads. EDAW was commissioned to conduct an Urban Design Study and produce a Master plan and Development Control Plan to aid Council in strategic redevelopment efforts. A community workshop was held to define the overall vision and desired future character statements.



Taylor Square context

The street closures produced 2 large public domain areas separated by heavily trafficked and noisy streets.



Key design principles

The community workshop affirmed the desire to unify the Square, provide cafe spill-out and integrate the Courthouse forecourt into the public domain.



Function and use

The use of the new public space is influenced by the businesses, civic space and streets that surround it and the pedestrian movement and shareways needed through the space.



Unifying elements

The thematic and consistent use of paving, trees and signage together with the definition of the existing buildings serve to unify the space and create two places.

Taylor Square, South Sydney, NSW

with EDAW, 1999

Client: South Sydney Council

The overriding outcome from the workshop was to unify the space and create two places of each side of Oxford Street. The design team established four unifying themes including, 1) the recognition of the existing building edges to define the space, 2) using significant vegetation to define quieter places, 3) paving areas consistently, and 4) the provision of two feature elements that will relate to existing privately owned sky signage and define the space at night. As project manager and lead urban designer, my responsibilities were to work with the design team including sub-consultants comprised of a social planner, public artist, town planner, transportation planner and heritage architect, and to lead all aspects of the project including analysis, design and report writing as well as administrative tasks including project coordination, financial tracking and client meetings.

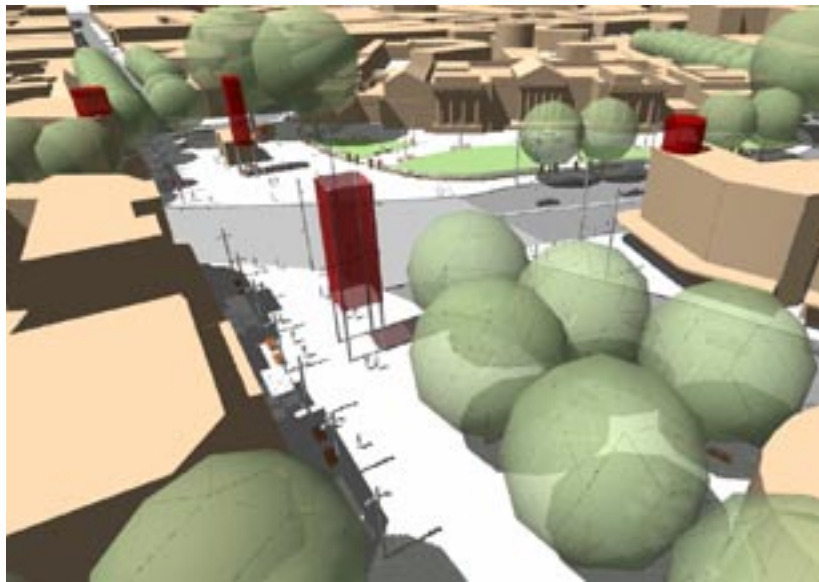

View from apartment block



Master plan



Existing condition



Existing traffic island